

LPS Print Competition Process

As specified by the vote of the members as of January 2010 there are two categories for the LPS photographic competition. Within each category, there are two types of entries: Color and Black and

White. Category A is for members who have previously earned ribbons or who desire intense competition. Category B is for newer members who have not yet earned ribbons. Members may choose to compete in either category, and may enter either color or black and white prints.

Members

who choose to compete in Category A may not later decide to compete in Category B without consent of

the Competition Committee. You may move from Category B to Category A at any time.

In order to expedite the process of dealing with the number of prints and the signing in of prints

into the proper categories, the following changes will become effective immediately.

1. **Category A prints will go in the first two sections (#1 & 2) of windows** (see drawing below). **Category B color prints will go in the first section of windows on the east side**

(#4). **Category B black and white prints will go in the next section of windows (#5).**

Category A black and white will go in the last section of windows (#6). That leaves one section (#3) for expansion as needed.

2. Each section of windows will have a **clipboard for sign in** so that fewer people are trying to access the same clipboard. Each clipboard will be labeled in accordance with the signage placed on each section of windows Example: Category B Color Prints, Section 1. Please look for this information and **make sure that you sign in on the correct line number on the correct sheet.**

A Recap of Some Old Rules:

3. Each window is to hold two prints. Photographs need to be 5X7 inches or larger for entry into the competition. Due to space constrictions, we ask that no print over **18X24 inches, including the mount board/mat be entered in the competition.**

4. It is not necessary, and not desirable to frame prints for competition (due to space restrictions). We ask only that they be **mounted or matted** for the protection of the print and in order to display them easily.

5. **The same image may be entered only twice.** A resubmission is accepted if the print did not win a ribbon the first time it was entered.

6. The name of the photographer is not to be visible on any print entered in the competition. Remember that **only members may enter the competition.**

7. One last new twist agreed upon by the Competition Committee to be more consistent with the digital projection: Blank cards will be available to you for giving your print a title. **Place the card, folded in half in front of your print so that the title shows. Do not put your name on the card.**

Hopefully the following drawing of the Garden Center will help explain the window sections.

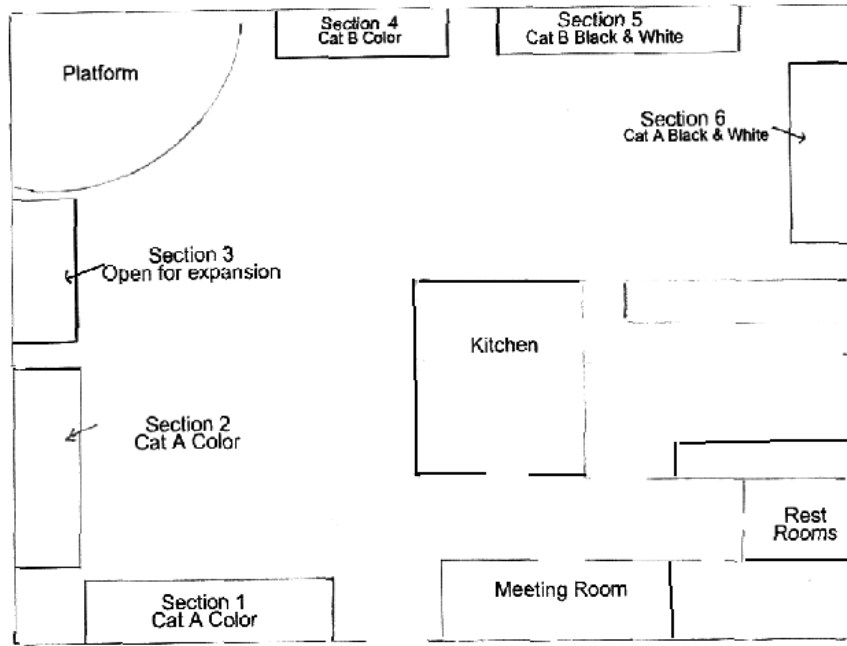

Garden Center

Front Entrance